

Terminal : Brass, Tin plated,0.8 t

Insulator body : PC(UL94V-0), Black

Screw : #6-32, steel, Ni plated

Operation temperatures : -40° C to +120° C

Rated current : 20Amp 300V

Insulation withstands volt : 2000V 1min

Insulation resistance : 2000MΩ at DC 500V

Wire range : 12-22 AWG

Screw torque : 12 lb-in

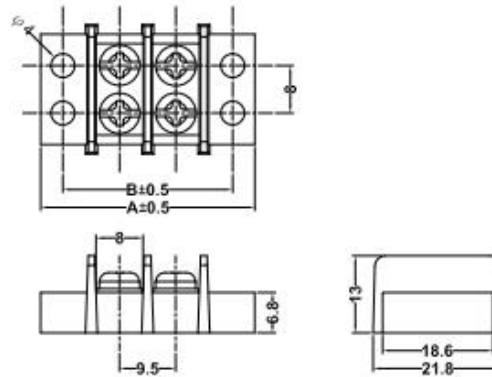

Poles	2	3	4	5	6	7	8	9	10	11	12	13	14	15	16
A(mm)	36.20	45.70	55.20	64.70	74.20	83.70	93.20	102.70	112.20	121.70	131.20	140.70	150.20	159.70	169.20
B(mm)	28.70	38.20	47.70	57.20	66.70	76.20	85.70	95.20	104.70	114.20	123.70	133.20	142.70	152.20	161.70
Poles	17	18	19	20	21	22	23	24	25	26	27	28	29	30	
A(mm)	178.70	188.20	197.70	207.20	216.70	226.20	235.70	245.20	254.70	264.20	273.70	283.20	292.70	302.20	
B(mm)	171.20	180.70	190.20	199.70	209.20	218.70	228.20	237.70	247.20	256.70	266.20	275.70	285.20	294.70	