

FUSE HOLDER

Panel PCB Mount

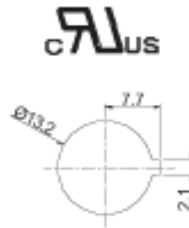

FH1-12M

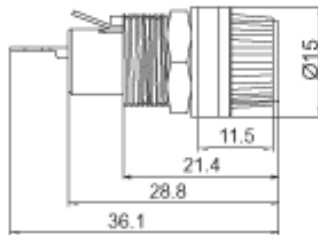

cut-out

Spec:

- Rating 10A 250Vac (UL, CUL)
- Terminal: 4.0 (0.156") solder
- Fuse Dimension: 5x20mm
- Mounting: nut
- Housing: PBT (UL94V-0)
- Panel thickness: max. 4.5mm



FH1-13

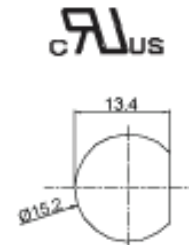
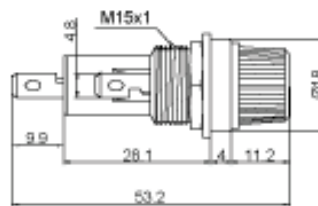

cut-out

Spec:

- Rating 10A 250Vac (UL, CUL)
- Terminal: 4.2 (0.163") solder
- Fuse Dimension: 6.4x30mm
- Mounting: nut
- Housing: PBT (UL94V-0)
- Panel thickness: max. 4.5mm



FH1-B-MW

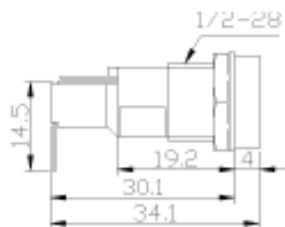

cut-out

Spec:

- Rating 10A 250Vac (UL, CUL)
- Terminal: 4.0 (0.156") solder
- Fuse Dimension: 5x20mm
- Mounting: nut
- Housing: PBT (UL94V-2)
- Panel thickness: max. 4.5mm



FH1-S-MZ

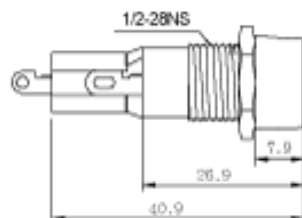

cut-out

Spec:

- Rating 10A 250Vac (UL, CUL)
- Terminal: 4.0 (0.156") solder
- Fuse Dimension: 5x20mm
- Mounting: nut
- Housing: PBT (UL94V-2)
- Panel thickness: max. 4.5mm

FUSE HOLDER

Panel PCB Mount



FH1-2

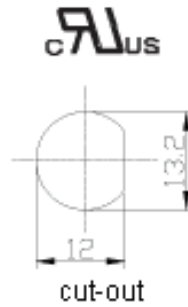
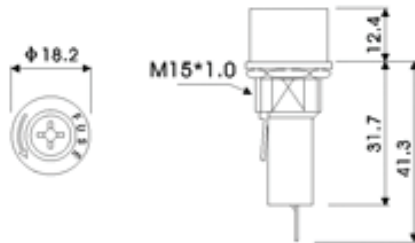

Spec:

- Rating 10A 250Vac (UL, CUL)
- Terminal: 4.8 (187) QC pin
- Fuse Dimension: 6x30mm
- Mounting: nut
- Housing: PBT (UL94V-2)
- Panel thickness: max. 4.5mm

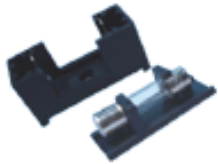

FH1-200C

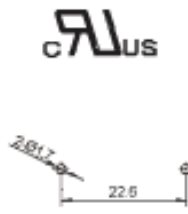
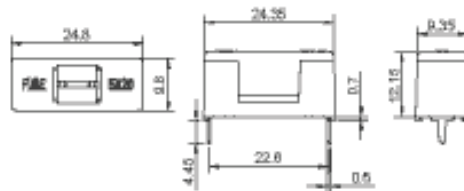

Spec:

- Rating 10A 250Vac (UL, CUL)
- Fuse Dimension: 5x20mm
- PCB mounting
- Housing: PBT (UL94V-2))

mounting hole



FH1-206W

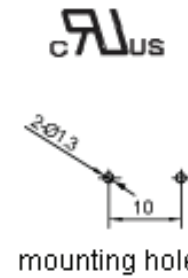
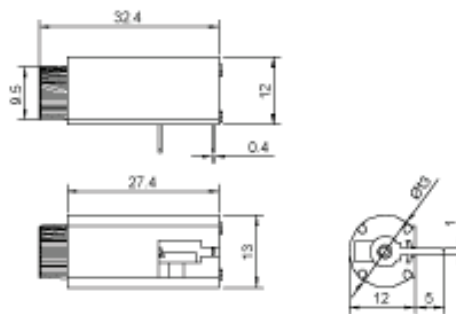

Spec:

- Rating 10A 250Vac (UL, CUL)
- Fuse Dimension: 5x20mm
- PCB mounting
- Housing: PBT (UL94V-2)

mounting hole



FH1-206Z

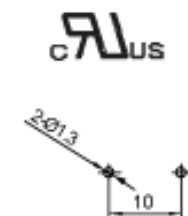
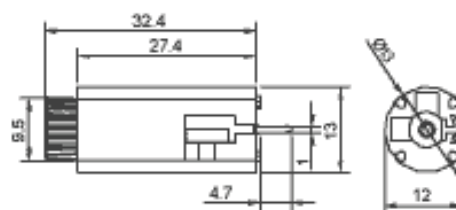

Spec:

- Rating 10A 250Vac (UL, CUL)
- Fuse Dimension: 5x20mm
- PCB mounting
- Housing: PBT (UL94V-2)

mounting hole

FUSE HOLDER

Panel PCB Mount



FH-201

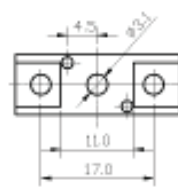
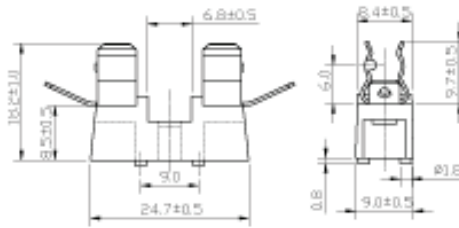

Spec:

- Rating 15A 250Vac (UL, CUL)
- Terminal: 4.8 (187) QC pin
- Fuse Dimension: 5x20mm
- Mounting: nut
- Housing: PBT (UL94V-2)



FH201-9

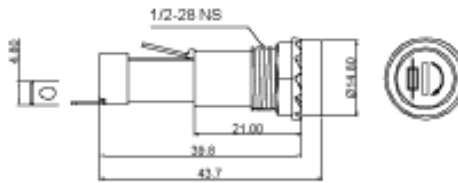

Straight terminal: FH201-9-PZ
Horizontal terminal: FH201-9-PW

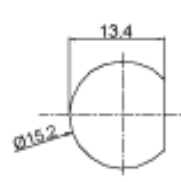

Spec:

- Rating 15A 250Vac (UL, CUL)
- Terminal: 4.8 (187) QC pin
- Fuse Dimension: 6x30mm
- Mounting: nut
- Housing: Phenolic (UL94V-0)
- Panel thickness: max. 4.5mm