

DIP SWITCH

RM, RV, RH SERIES

- Mechanical Life: 20,000 steps, 200m Ohm max.
- Operational Force: 200gf
- Operating Temp.: -40~85 degrees in Celsius
- Non-switching rating : 100mA,50VDC.
- Switching rating : 25mA, 24VDC.
- Contact resistance : 100m Ohm max. at initial.
- Insulation resistance : 100M ohm min at 250VDC
- Dielectric strength : 250VAC/1minute.
- Base&Cover : UL94V-0 Nylon, black color
- Actuator : UL94V-0 LCP Thermoplastic, white color
- Contact : Copper alloy with gold plated over nickel
- Terminals : Brass with gold plated

How to order:

R	M	4	A	—	10	R	—	T/R
SERIES SYMBOL	TERMINAL TYPE	TERMINALS NO	ACTUATOR TYPE	TERMINAL	NUMBER OF STEPS	REAL CODES		PACKAGE STYLE
	H THROUGH HOLE V RIGHT ANGLE M SMT	4 4X1 3 3X3 2 3X2	RECESSED H HIGHT ACTUATOR M 3.2mm	A GOLD PLATED OVER NICKEL	10 10 STEPS 16 16 STEPS	R		TUBE T/R TAPE & REEL (FOR RM ONLY)

RM4A-10/16R

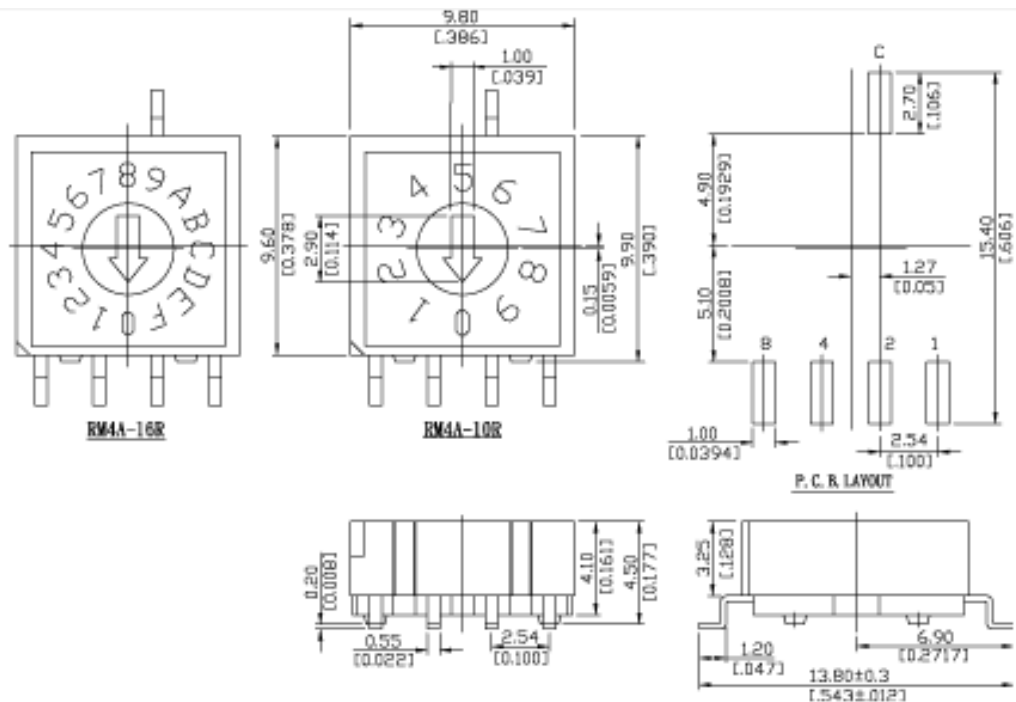

DIP SWITCH

RM, RV, RH SERIES

RH2A-10/16R

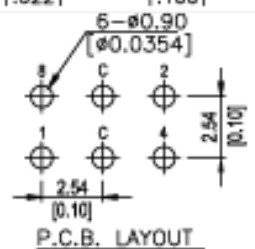
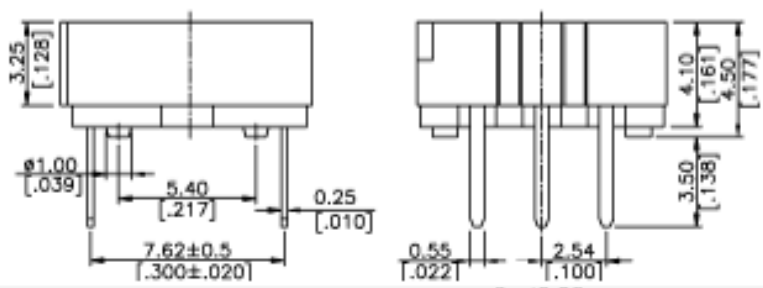
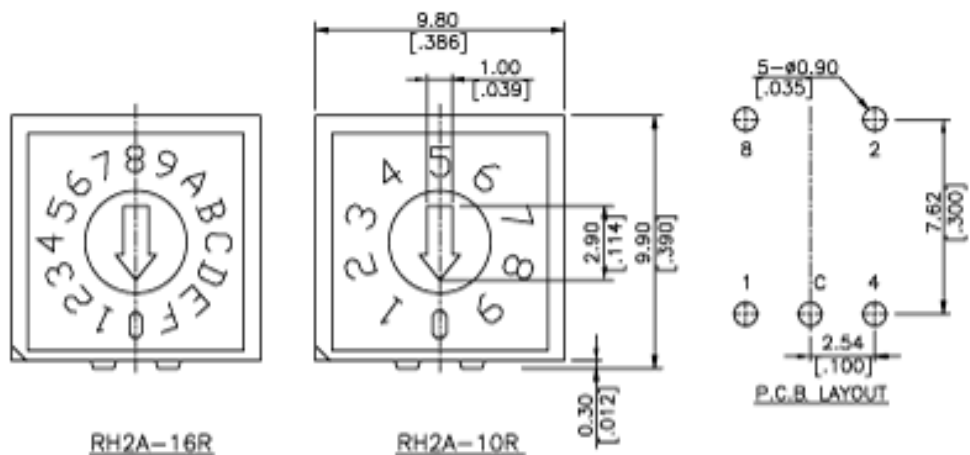

RV3A-10/16R

